

EN54-4

SBC-EN54-13V8-10A

Buy online at www.stadiumpower.co.uk

SBC-EN54-13V8-10A Power Supply

Features:



- Single output plus battery charger
- Deep discharge battery protection
- Reverse battery protection
- High efficiency
- Cased unit
- Low cost
- Low touch currents
- Designed to meet the requirements of EN54-4 1998 inc Amends 1&2
- Meets requirements of EN61000-3-2 PFC Class A
- Meets requirements of EN55022 'B' for conducted noise

Product can be adapted to customer requirements with regard to o/p signals and signal levels

Specification:

INPUT	
Input voltage	220 – 240 Vac +/-10%
Frequency Range	50-60Hz
Temperature Range	0 – 45°C ambient (Convection cooled, cased)
Input fuse	T2H 250V TR5
Input Current	1.5Arms (200Vacin, full load)
Hold-up Time	20mS (230Vacin, full load, no battery connected)
Power Factor	0.5 (230Vacin, Full load)
No Load Power	2W (230Vacin)
Start-up	Less than 1.5 seconds
OUTPUT	
Output Voltage	13V8 (Factory set for operation with optional thermistor)
Output Current	8.0A
Power limit	115% +/-10%
Efficiency	Up to 82% (230Vacin, Full load)
OVP	105-125% (latching and non dissipative) recycle input to restart
Short Circuit protection	Hiccup mode
Signals	Mails Fail, Battery O/C, Charger Loss, Battery Low LED's & open collector - 100mA sink, Status LED green= Flashing = OK Common Fault (Volt Free) relay 2x Customer options - open collector - 30mA Sink HiZ indication (0.2Ω) Battery Power Fail signal = 100mS
Current limit	Primary side power limit
Thermal protection	Primary side thermal protection (non-latching)
Load regulation	+/- 0.75% (Before OR-ing diodes)
Line regulation	+/- 0.5%
Noise & ripple	0.5% (230Vacin, Full load, BW = DC – 10MHz)
BATTERY	
Charger	Current limited, 2.0A
Temp compensation	Connector provided for user to add 100KΩ thermistor (β=4400) Suitable for standby use
Deep discharge protection	10V +/-0.25V
Fuse	15A 32V mini blade, automotive

Specification:

ENVIRONMENT	
Temperature	-10°C to +70°C (Derate 2.5%/°C above 45°C)
Cooling	Convection only
Humidity	10-95% non-condensing
Storage	-25°C to +85°C
MTBF	>80,000 hrs 25°C (MIL217F parts count method)
SAFETY & REGULATORY SPECIFICATIONS	
PSU Class	Class I:- Component part
Safety	Certified to EN60950, CE marked against LVD Designed to meet UL60950
Flash test	Uncased units: I/p to O/p 4300V DC Cased units: I/p to O/p & E 2200V DC
Earth leakage current	<750uA rms (230Vacin 50Hz)
Output touch current	<175uA rms (230Vacin 50Hz)
EMC – Conducted	Designed to meet requirements of EN55022 “Class B”
EMC – Radiated	Designed to meet requirements of EN55022 “Class A”
EMC - Power Factor	Designed to meet requirements of EN61000-3-2 “Class A”
EMC – Fast Transients	Designed to meet requirements of EN61000-4-4
EMC – Surge	Designed to meet requirements of EN61000-4-5
EMC – Voltage Dips & Fluctuations	Designed to meet requirements of EN61000-4-11
	EMC will need re-evaluating in final system
MECHANICAL	
Dimensions	159x132x59.5mm
Fixings	123x83 for M3
Case Material / Finish	Zintec
Input Connector	CAMDEN CTB0118 or equivalent
Output Connector	Power = CAMDEN CTB0108 or equivalent Battery = CAMDEN CTB0118 or equivalent Signal = MOLEX 6410 Vertical friction lock or equivalent
Pin-out	See below
Weight	650 grams

Technical specification may be subject to change – contact sales office before ordering.

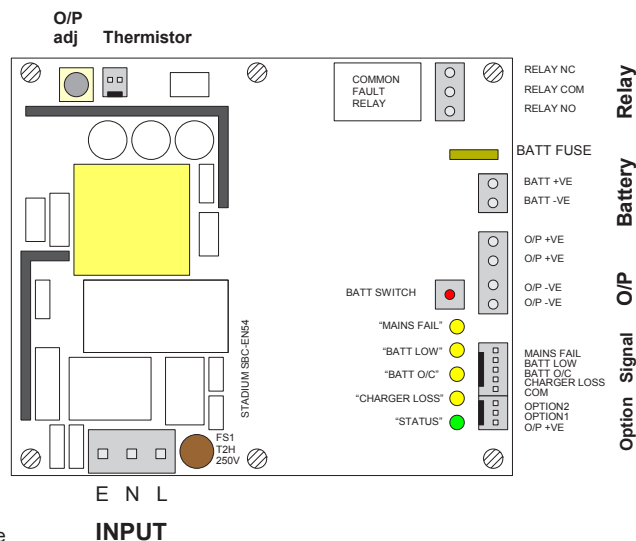

Data sheets are subject to change without notice

Rev no. 19062013